

REUSABLE PUMP SET CLEANING INSTRUCTIONS

After each use by the same mother

Please refer to the full product instructions for use directions for sterilising the Symphony reusable pump set if used between different mothers.

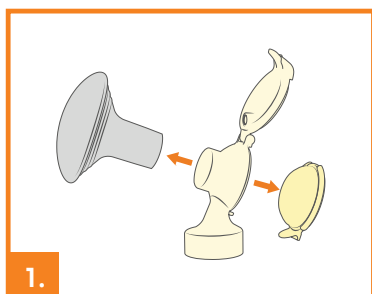

Disassemble the pump set into its individual parts:

- breast shield
- connector and connector lid
- membrane

Check all parts for damage.

Replace damaged or worn parts.

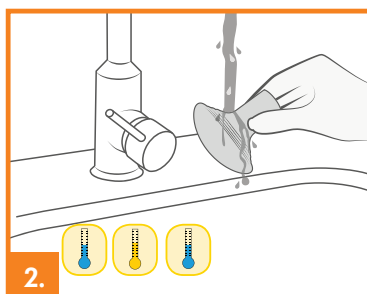

Rinse all parts with cold, clear drinking-quality water (approx. 20 °C).

Clean these parts with plenty of warm, soapy water (approx. 30 °C).

Use a commercially available washing-up liquid, preferably without artificial fragrances and colouring (pH neutral).

Rinse the parts with cold, clear drinking-quality water (approx. 20 °C).

3. Drying / storage

Dry with a clean cloth or leave to dry on a clean cloth.

Put the clean parts in a clean storage bag or a clean environment.

Do not store parts in an airtight container/bag. It is important that all residual moisture dries.

! Ensure the membrane is dry. Inspect the entire membrane and valve at the base for any tears, holes or damage. Replace the membrane if it is damaged in any way.

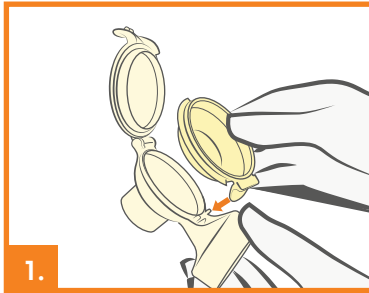

1.

Wash your hands thoroughly with soap and water before touching the clean breast pump, the pump set(s) and breasts.

Dry your hands with a fresh towel or a single-use paper towel.

Avoid touching the inside of bottles and lids.

Carefully place the membrane into the connector with the flap into the opening of the connector.

Make sure that the membrane forms a seal around the edge of the connector.

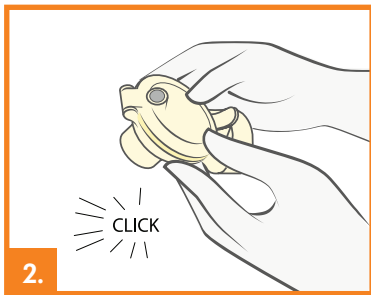

2.

Close the connector lid until it audibly clicks.

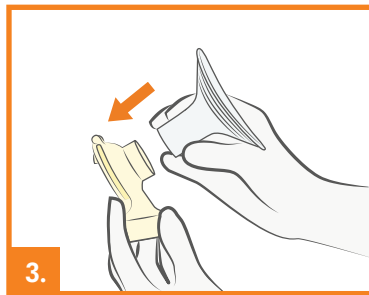

3.

Carefully push the breast shield onto the connector. Choose a breast shield size that suits your needs.

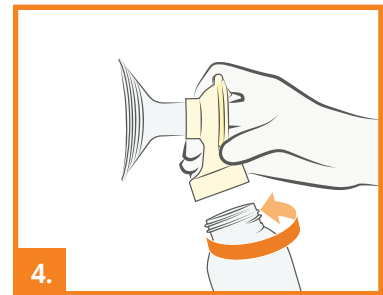

4.

Screw the connector onto the bottle. Choose a bottle size that suits your needs.

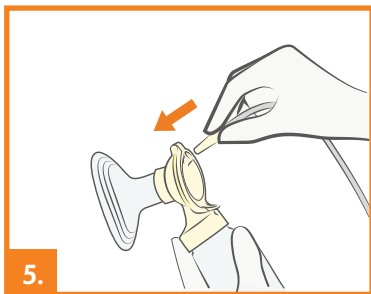

5.

Insert the tubing adapter into the corresponding opening in the connector lid.

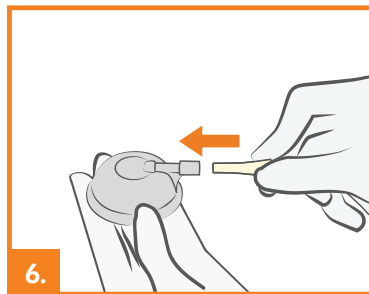

6.

Insert the tubing adapter into the opening in the Symphony cap.

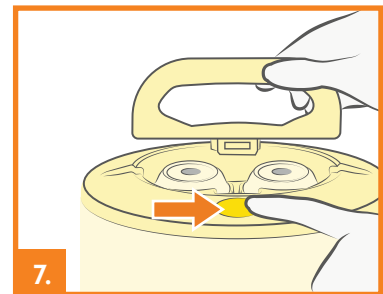

7.

Open the lid of the breast pump: Press the oval button on the top of the Symphony pump and lift the handle.

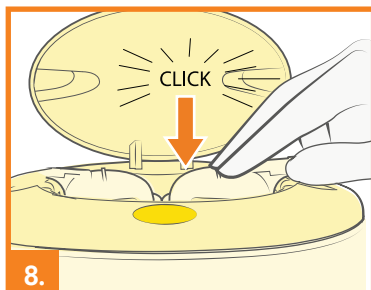

8. Position the Symphony cap firmly on the breast pump membrane to form a seal.

* Make sure that the Symphony cap engages and lies flush to the surface.

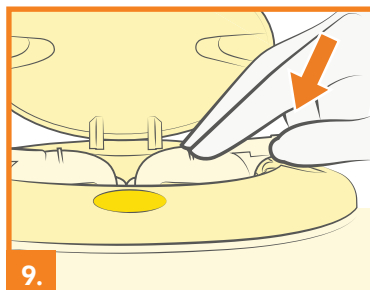

9. Centre the tubing connector in the recess in the pump housing.

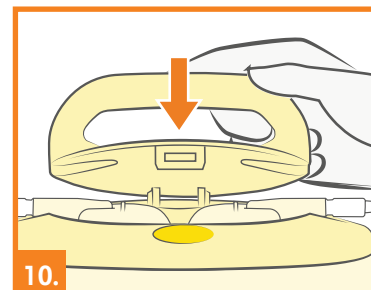

10. Close the lid.

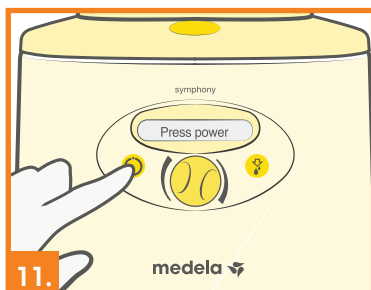

11. Switch on the breast pump with . Proceed with the program selection.

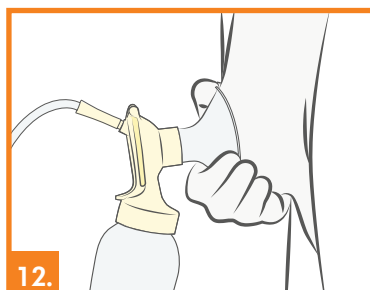

12. Place the breast shield of one bottle on the first breast so that the nipple is properly centred in the tunnel.

The PersonalFit PLUS breast shield is oval and can be rotated (360°) and placed in the desired position which is most comfortable for you.

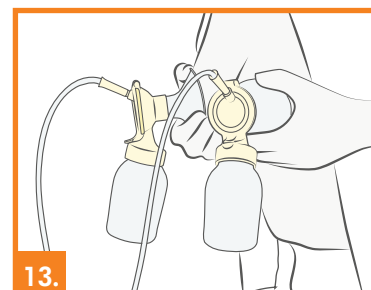

13. Place the breast shield of the second bottle on the other breast so that the nipple is properly centred in the tunnel.

Operate the pump as appropriate for the selected program.